

AGENDA SUPPLEMENT (1)

Meeting: Cabinet Capital Assets Committee
Place: The Kennet Room - County Hall, Trowbridge BA14 8JN
Date: Tuesday 17 January 2017
Time: 10.00 am

The Agenda for the above meeting was published on 9 January 2017. Additional documents are now available and are attached to this Agenda Supplement.

Please direct any enquiries on this Agenda to Will Oulton, of Democratic Services, County Hall, Bythesea Road, Trowbridge, direct line 01225 713935 or email william.oulton@wiltshire.gov.uk

Press enquiries to Communications on direct lines (01225)713114/713115.

This Agenda and all the documents referred to within it are available on the Council's website at www.wiltshire.gov.uk

8 **Assets to be declared surplus (Pages 3 - 10)**

List of sites under discussion

DATE OF PUBLICATION: 11 January 2017

This page is intentionally left blank

SUPPLEMENTAL ANNEX – List of Assets

Wiltshire Council

Cabinet Capital Assets Committee

17th January 2017

SITE DETAILS

SITE 1.

Broad Hinton – Land adjoining Tom Gallagher Van Centre

UPRN – 07009S1

Location Plan – Site Extent Subject to Survey (Not to Scale)

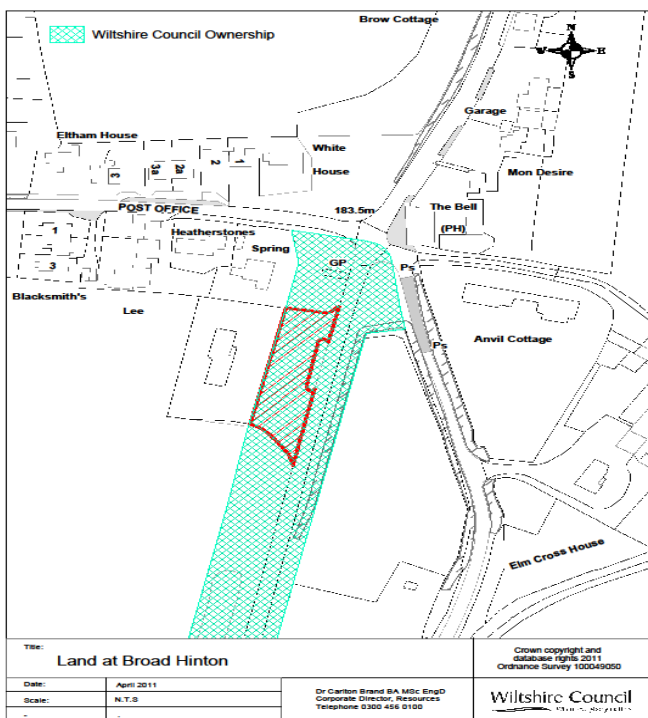

SITE 2.

Chippenham – Land at Darcy Close

UPRN – 10002S1

Location Plan – Site Extent Subject to Survey (Not to Scale)



Rawlings Green Chippenham

Date: 19 Feb 2015
Centre Coordinate: 392,933 173,917

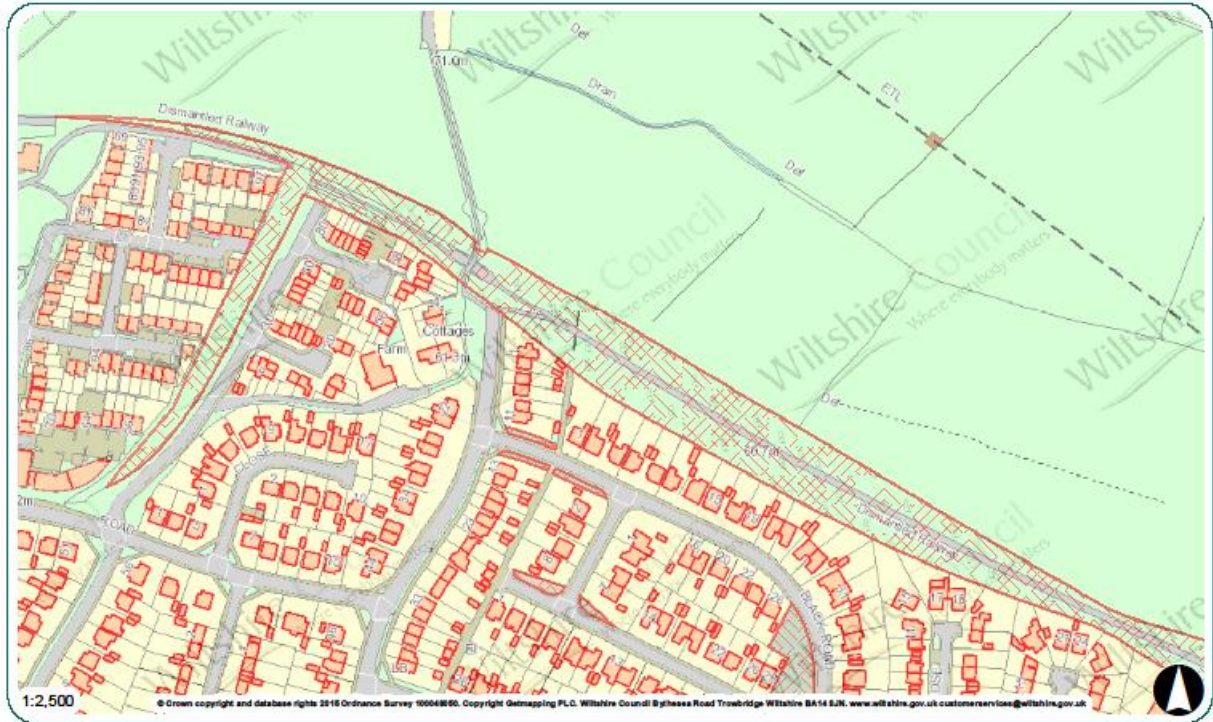

SITE 3.

Tisbury - Former Youth Centre

Location Plan – Site Extent Subject to Survey (Not to Scale)

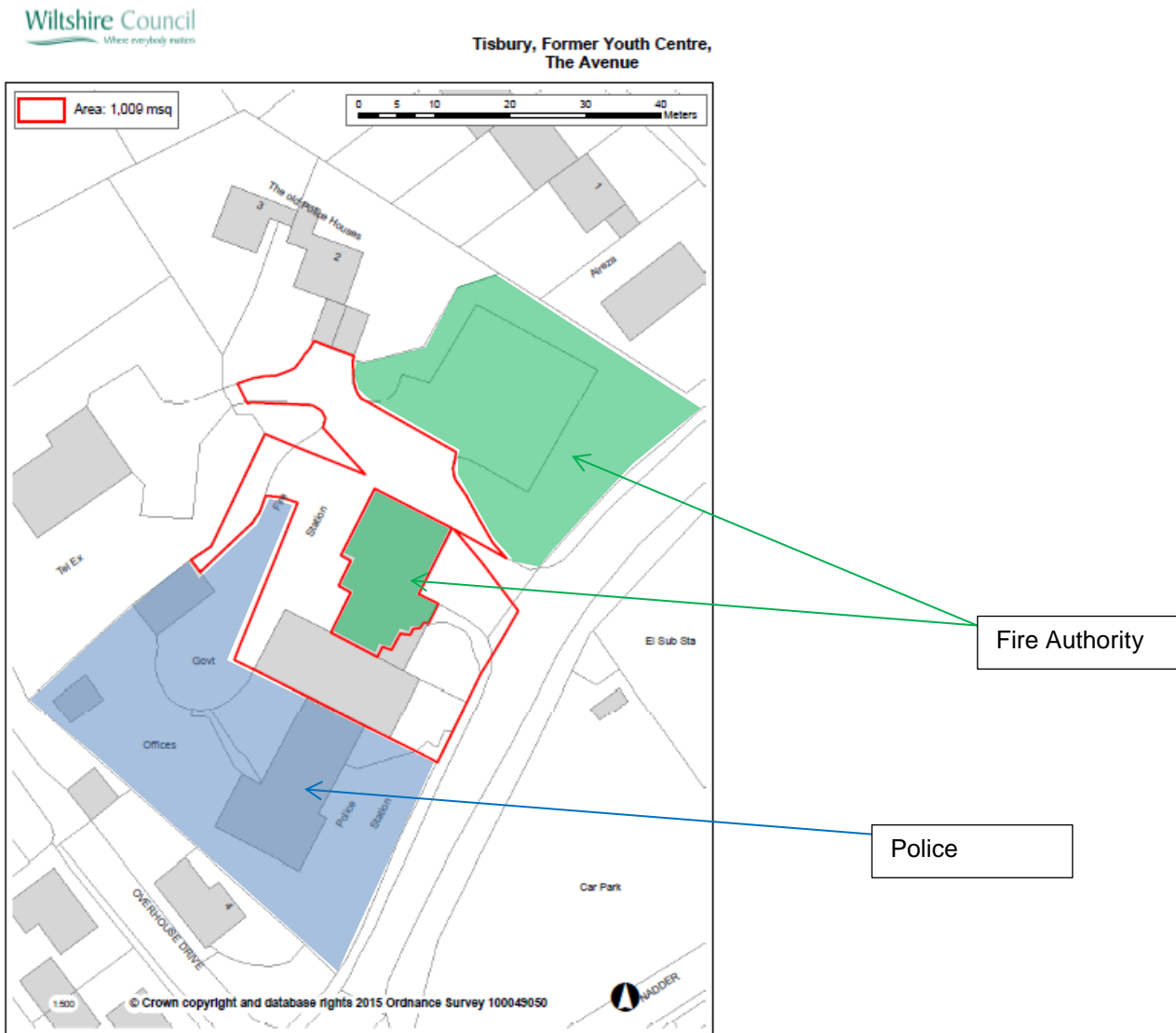

SITE 4.

Trowbridge – Bradford Road Car Park

UPRN – 20317S2

Location Plan – Site Extent Subject to Survey (Not to Scale)



**Trowbridge
Bradford Road Car Pak**



SITE 5.

Warminster – former Household Recycling Centre, Furnax Lane

UPRN – 01310S1

Location Plan – Site Extent Subject to Survey (Not to Scale)

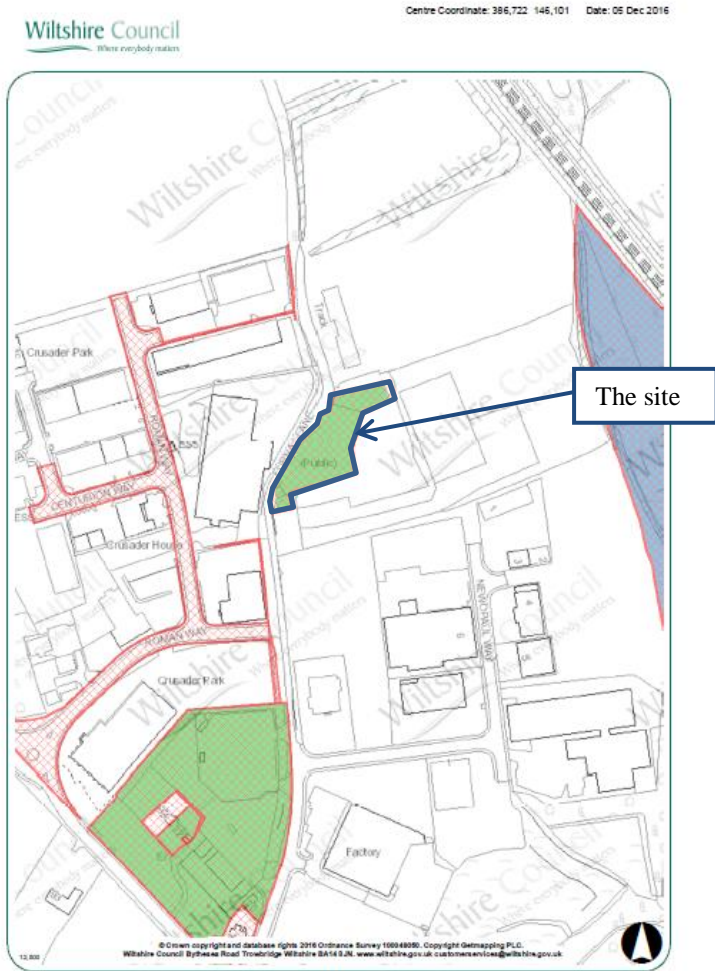

SITE 6

2 Middle Lodge, Pewsham, Chippenham, Wiltshire, SN15 3QY

UPRN – 03046S8

Location Plan – Site Extent Subject to Survey (Not to Scale)

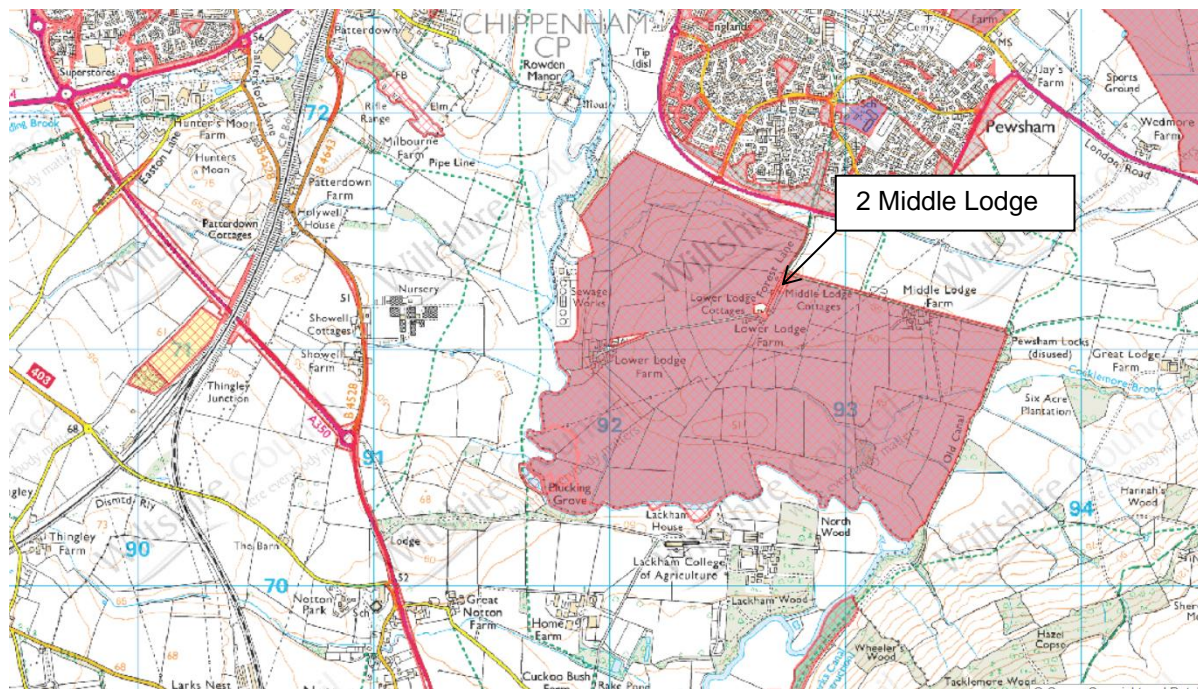

SITE 7.

Corsham Railway Embankment, South Side – Parcel of land

UPRN – Part of 10125S1

Location Plan – site for transfer denoted by pink shading

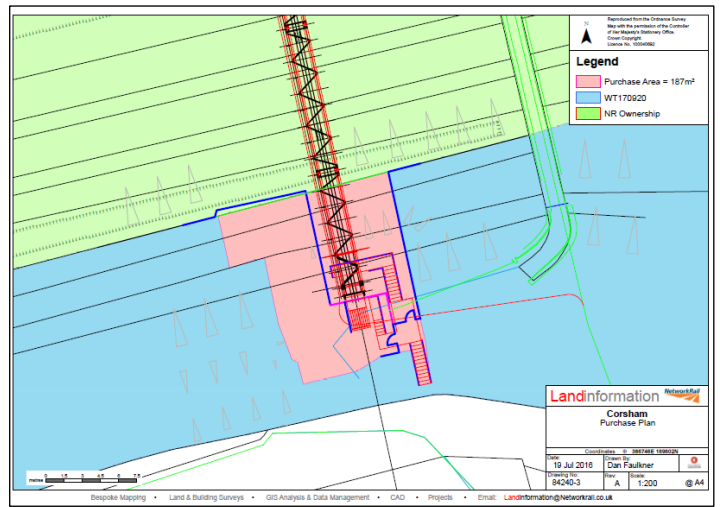
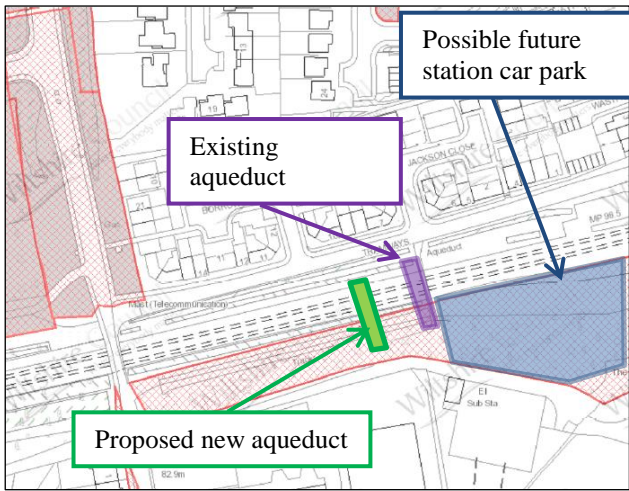

This page is intentionally left blank